

RoHS

REV.	DESCRIPTION	DATE
A		06-2013

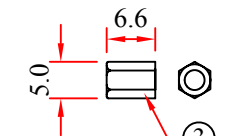
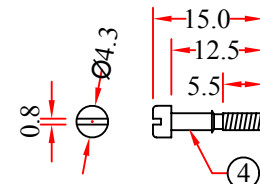
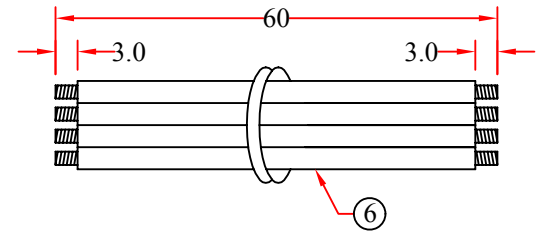
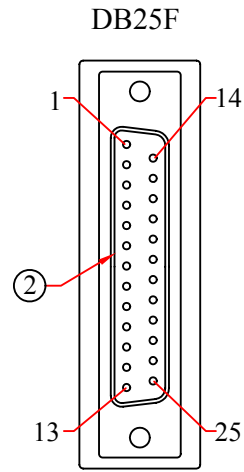
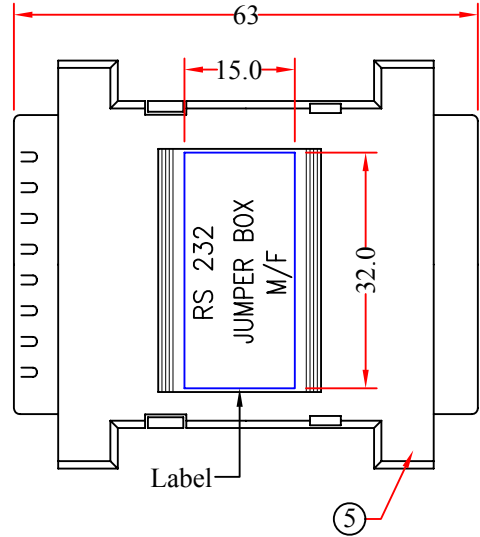
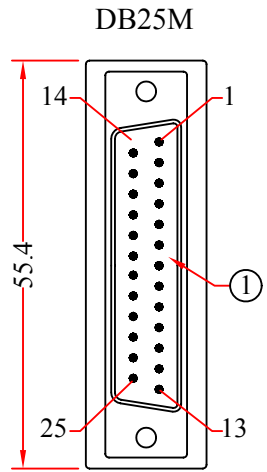

SCREW

HEX-NUT 5\*6.6mm

Packing:

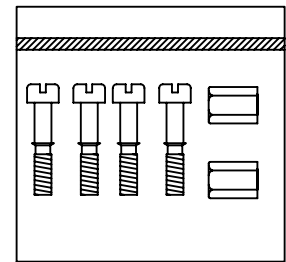

NO.	SPECIFICATIONS
6	UL1007 26AWG Wire,Length 60mm
5	PCB: MSL-7, Electro-Plated Hood
4	Screw #4-40, 4*12.5mm,With Pad, Assembly Type
3	Hex-Nut 5*6.6mm
2	DB25 Female, Gold Flast On Contacts, Blue Insulator
1	DB25 Male, Gold Flast On Contacts, Blue Insulator
BOM LIST	

ITEM NUMBER	31D3-44200			DRAWER	JL
TITLE	RS-232 Jumper Box, DB25 Male to DB25 Female			CHECKED	
				APPROVED	
MATERIAL		SCALE		⊕	◁
REV.	A	UNIT	MM		
DRAWING NO:				