

Rev.	Description	Date
A		07-2023

**SUGGESTED MOUNTING CUTOUT**

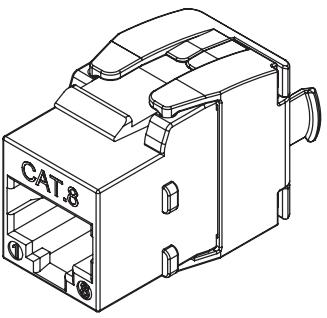
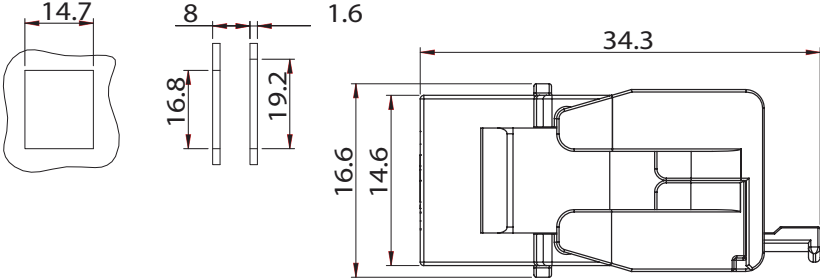

**ACCORDING TO**

- ANSI/TIA-568.2-D
- ISO/IEC 11801-1
- IEC 60603-7
- IEEE 802.3bt Power over Ethernet Plus Plus(4PPoE) application
- IEC 60512-99-002 Mating and un-mating connectors under electrical load

**MATERIAL**

- BRACKET : NICKEL SILVER ALLOY.
- KEYSTONE JACK HOUSING : ZINE ALLOY,NICKEL PLATED.
- REAR HOUSING : ZINC ALLOY,NICKEL PLATED.
- KEYSTONE JACK LATCH : PC+ABS,UL94V-0.
- CONTACT HOLDER : PC,UL94V-0.
- JACK CONTACTS : PHOSPHOR BRONZE,50U" GOLD PAINTING.
- IDC PLASTIC : PC,UL94V-0.
- IDC TERMINALS : PHOSPHOR BRONZE,TIN OVER NICKEL UNDERCOAT.

**PHYSICAL CHARACTERISTICS**

- INSERTION LIFE : 750 MATING CYCLES WITH FCC COMPLIANT 8P PLUG.
- PLUG RETENTION FORCE : 11 LBF MINIMUM.
- DURABILITY : 30 TERMINATION CYCLES.
- CONTACT COMPATIBILITY : ACCOMMODATES 22 TO 24 AWG SOLID.
- OPERATING TEMPERATURE RANGE : -10 °C TO 60°C.
- STORAGE TEMPERATURE RANGE : -40 °C TO 68°C.
- HUMIDITY : 10% TO 90% RH (NON-CONDENSING).

**ELECTRICAL**

- INSULATION RESISTANCE : 500 MΩ MINIMUM.
- DC CURRENT RATING : 1.5 Amps.
- INPUT TO OUTPUT D.C. RESISTANCE : 100 mΩ MAXIMUM.
- CONTACT RESISTANCE : 20 mΩ MAXIMUM.
- VOLTAGE PROOF (CONTACT TO CONTACT) : 1000 V AC.
- VOLTAGE PROOF (CONTACT TO SHIELD) : 1500 V DC.

**NOTE**

ONLY ACCEPT RJ-45 8P8C PLUG.

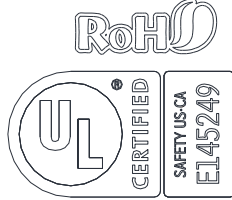
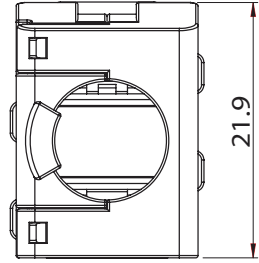
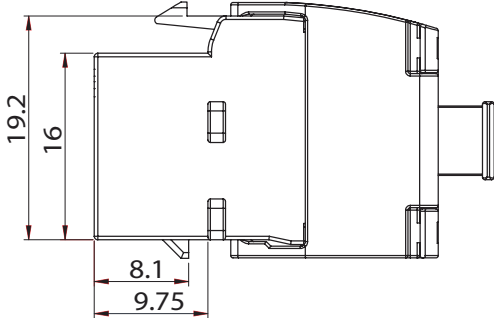
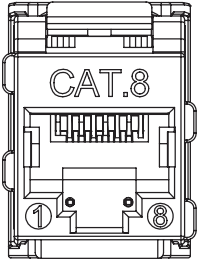

**ENCLOSURE**

- IDC CAP X 1 PC
- NYLON CABLE TIE X 1 PC
- INSTRUCTION X 1 PC

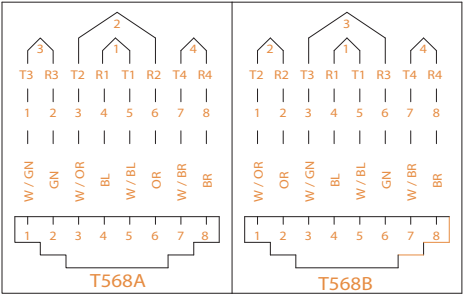
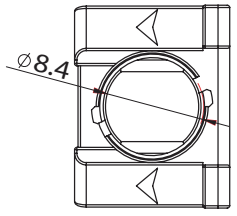
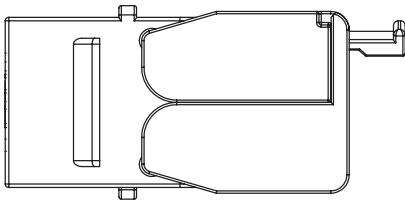

Item Number:	33X8-530	
Title:	Shielded Cat8 Keystone Jack, 40Gbps, Toolless, RJ45 Female	
Drawn by:	JL	
Approved by:	MAC	
ID:	108	