

REV.	DESCRIPTION	DATE
A		05-2013

RoHS

Electrical Requirements			
Type	Frequency (MHz)	Insertion Loss (dB Max)	Return Loss (dB Min)
A	1000	0.25	16
B	2500	0.25	24
C	3000	0.25	30

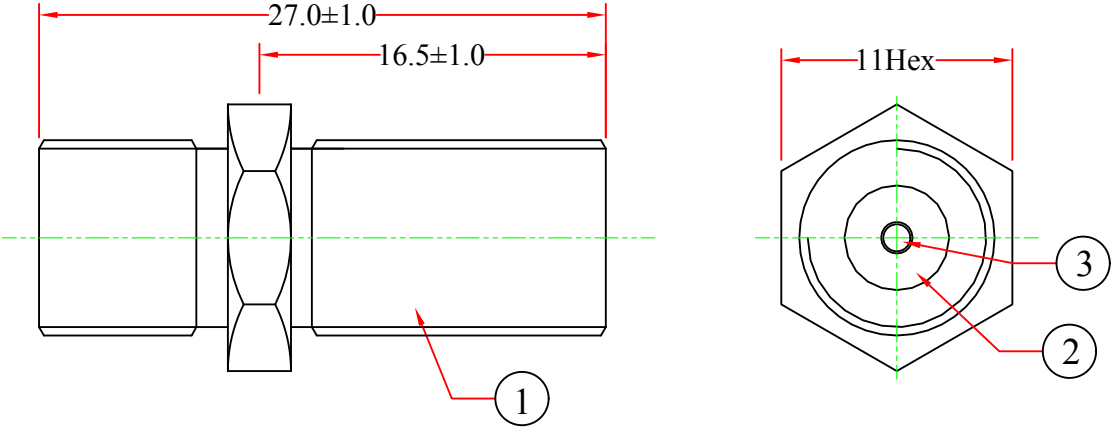

F-Pin (Coax) Coupler, Female / Female

Mechanical Requirements				
Type	Dielectric Color (Pantone No.)	Seizing Pin Contact Points	Min Torque Withstand	Operating Temperature
A	Red(032C)	2	40 in.lb	-40°C~ 40 °C
B	Blue(801C)	4	40 in.lb	-40°C~ 40 °C
C	Green(802C)	4	40 in.lb	-40°C~ 40 °C

Type	PART NO.	Dielectric Color
A	ASF-20057	Red
B	ASF-20058	Blue
C	ASF-20059	Green

ITEM NUMBER	ASF-20057 & 8 & 9		DRAWER	JL
TITLE	F-pin Coaxial Coupler, F81, F-pin Female		CHECKED	
			APPROVED	
MATERIAL		SCALE		
REV.	A	UNIT		MM
DRAWING NO:				

3	Seizing Pin, Beryllium Copper, Ag Plated
2	Dielectric Polyethylene
1	Body, Nickel Plated, Machined, 3/8"-32 UNEF 2A
NO.	SPECIFICATIONS
	BOM LIST